

# INOSYS 87E22081

800A UL 98B 1500VDC



INOSYS ESS LBS is a range of load break switches that can be manually controlled. These switches can be operated manually using the handle to disconnect all or part of the electrical installation. They ensure on-load opening / closing and safe disconnection of any direct current low voltage electrical circuit up to 1500 VDC. They can also be used for emergency power switching applications. They have been specifically designed to withstand high short circuit conditions in DC and ESS applications.

## General Information

Product range :	INOSYS LBS ESS
Long Description:	INOSYS 87E22081 INOSYS LBS ESS 800A UL 2P2 1500V
Short Description:	INOSYS LBS ESS 800A UL 2P2 1500V

## Certificates and declaration

Conformity to standard #1:	UL98B
----------------------------	-------

## Container Information

Product per package:	1
----------------------	---

## Main

Reference:	87E22081
Rating (A):	800
Number of poles:	2P+2

## Ordering

Country of origin:	FRANCE
--------------------	--------

## Technical characteristics

Rating (A)	800
------------	-----

### IEC Electrical characteristics

As per UL98B	Disconnect switch, frame	F3
	Rated insulation voltage $U_i$ (V)	1500
	Rated impulse withstand voltage $U_{imp}$ (kV)	12
	Utilization category for $U_e=1500V_{dc}$	UL 98B 1000
	<b>Short circuit capacity</b>	
	Prospective short circuit current (UL 98B) (kA)	10
	Rated short-time withstands current 1s. $I_{cw}$ (kA rms) (IEC 60947-3)	20 (1sec) 63 (0,1sec)
	Instantaneous $I_{cc}$ max (kA) (IEC 60947-3)	120kA at (I/r) 0.5ms 80kA at (I/r) 3ms
Power dissipation W/p (at maximum $I_e/U_e$ )	14	

### Mechanical characteristics

	Mechanical durability (nb of operating cycle without load)	8000
	Operating temperature without derating	40
	Maximum weight (without bridging links)	6,6

### Connection terminals

Maximum Cu Busbar dimensions (width) (mm)	10 x 100
Maximum rigid cable cross-section Cu for each side (mm <sup>2</sup> )	4 x 400
Tightening torque min (Nm):	35
Tightening torque max (Nm):	42,4

## Dimensions

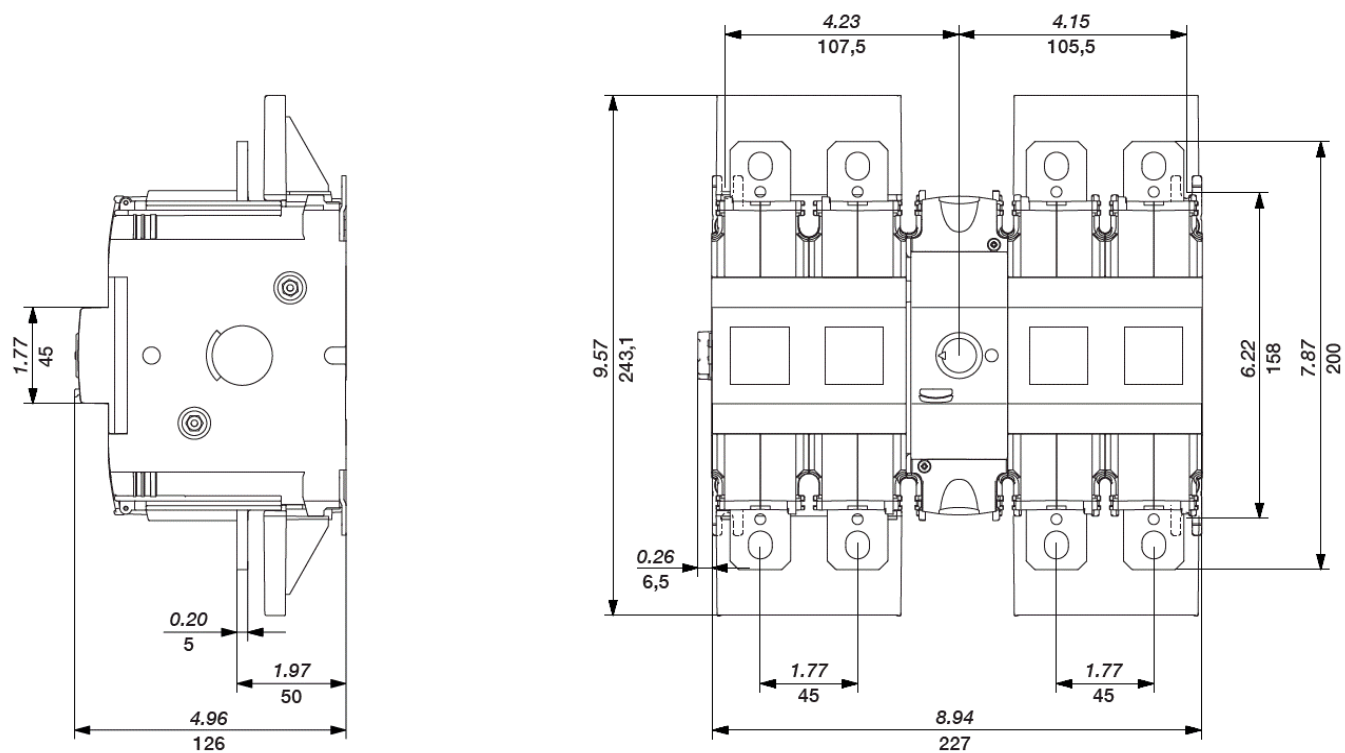

## Connection

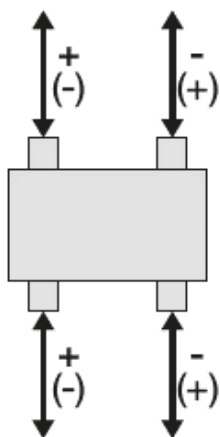

Using  
84091600  
BRIDGING BAR  
F3 1600A

Using Manual  
External: S2L

Using shaft S  
10x10  
140010XX (XX=  
20 to 40)

Using Lugs  
CMC PV2-600  
39542060  
39543060

Using Aux.  
Contact Screw  
NO+NC STD  
84990001

Using Aux  
Contact Screw  
NO+NC Low  
level  
84990002

Using Aux  
Contac Screw  
NC 600V  
84990003